

1 Function Ex-d IIC / Ex-e II / Ex-td Brass Cable Gland

Technical details	
Approved by	IMQ
Examination Certificate Number	IMQ 11 ATEX 038 X
Examination & Test Report Number	43L00002
Safety Requirements	EN 60079-0:2009 / EN 60079-1:2007 / EN 60079-7:2007 / EN 60079-11:2010 / EN 60079-31:2009
Equipment Marking	Flameproof Ex-d and Increased Safety Ex-e EX II 2GD EX d IIC Gb / Ex e IIC Gb
Suitable for use in	ZONE1, ZONE2, ZONE21, ZONE22 for Gas Groups IIA, IIB, IIC
For	Gas & Dust potentially explosive atmospheres
Degree Of Protection	IP66-IP68 (EN 60529)
Marking	BMD BU.. CE0722 II 2GD Exd IIC Gb / Exe IIC Gb Ta-30°C +120°C Ex t IIIC Db IP66/68 IMQ 11 ATEX 038X
Temperature Classes	-30°C / +120°C with NBR Sealing Ring -40°C / +100°C with NEOPRENE Sealing Ring -60°C / +180°C with SILICONE Sealing Ring
Material (Δ)	B – Brass X – Stainless Steel



Code	M ISO pitch 1,5	Code	M ANSI ASME B1.20.1	Dimensions				Ø Sealing Ring Dimension min-max	S1+S2+S3	S1+S2	S1
				L	L1 min	CH	H min				
BU01MΔ	16	BU01NΔ	3/8"	40	16	22	20	3,0-12,0	3-6	6-9	9-12
BU1MΔ	20	BU1NΔ	1/2"	40	16	22	20	3,0-12,0	3-6	6-9	9-12
BU12MΔ	20	BU12NΔ	1/2"	45	16	28	20	10,0-16,0		10-13	13-16
BU2MΔ	25	BU2NΔ	3/4"	40	16	28	20	10,0-18,0		10-13	13-18
BU23MΔ	25	BU23NΔ	3/4"	50	16	35	25	14,0-20,0		14-17	17-20
BU3MΔ	32	BU3NΔ	1"	43	16	35	25	14,0-24,0	14-17	17-20	20-24
BU34MΔ	32	BU34NΔ	1"	53	16	45	39	22,0-28,0		22-26	26-28
BU4MΔ	40	BU4NΔ	1 1/4"	45	18	45	39	22,0-32,0		22-26	26-32
BU45MΔ	40	BU45NΔ	1 1/4"	55	18	50	32	26,0-34,0		26-30	30-34
BU5MΔ	50	BU5NΔ	1 1/2"	46	18	55/50	32	26,0-35,0		26-30	30-35
BU56MΔ	50	BU56NΔ	1 1/2"	63	18	55/58	38	35,0-44,0		35-38	38-44
BU6MΔ	63	BU6NΔ	2"	53	18	68/58	38	35,0-45,0		35-38	38-45
BU67MΔ	63	BU67NΔ	2"	62	18	75/80	25	45,0-57,0	45-49	49-53	53-57
BU7MΔ	75	BU7NΔ	2 1/2"	64	20	80	25	46,0-62,0	46-51	51-57	57-62
BU78MΔ	75	BU78NΔ	2 1/2"	75	20	95	36	60,0-70,0	60-63	63-69	69-70
BU8MΔ	90	BU8NΔ	3"	75	20	95	36	60,0-75,0	60-63	63-69	69-75
BU810MΔ	90	BU810NΔ	3"	77	20	105	38	75,0-85,0	75-79	79-82	82-85
BU10MΔ	100	BU10NΔ	4"	77	20	105	38	75,0-85,0	75-79	79-82	82-85
BU11MΔ	110	BU11NΔ	4"	77	20	115	38	85,0-95,0	85-89	89-92	92-95

Item	Item Description
1	Sealing ring
2	Cap
3	Body

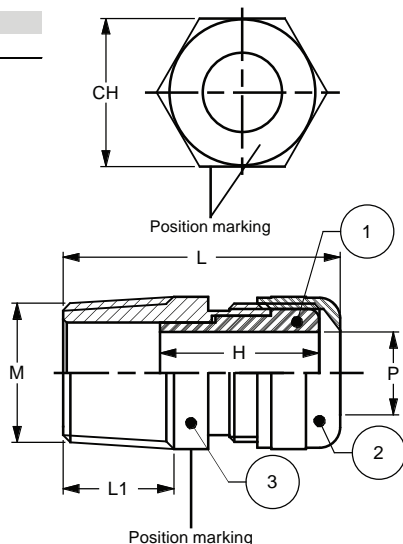

P - Sealing Combination

